

morphy richards®



Bagless cylinder vacuum cleaner

 Please read and keep these instructions

Getting the best from your new cleaner...

If your cleaner is not picking up as well as it should, please check

Dust canister

It is important to regularly empty the canister, even if it does not appear full.

Filters

It is important that the dust canister pleated/mesh filter is tapped and brushed clean over a dustbin each time the dust canister is emptied, this allows air through the appliance. Wash the canister filters regularly in luke-warm water and allow to air dry before re-fitting.

Blockages

Check nozzles, tubes and hose and dust canister connector for blockages or partial blockages that may impair the performance of the cleaner.

Eco switch and air-flow control

When maximum suction is required, make sure the air-flow control is closed and the Eco Switch is set to MAX.

VC73270 MUK Rev 2



If you have a problem or complaint, please call our dedicated UK based helpline before returning your product to the retailer from where it was purchased.

 UK Helpline: 0844 871 0949
Replacement Parts: 0844 873 0715
Ireland Helpline: 1800 409 119

For details of other Morphy Richards products, plus replacement parts and accessories, please see our website:

www.morphyrichards.com



IMPORTANT SAFETY INSTRUCTIONS

The use of any electrical appliance requires the following common sense safety rules.

Primarily there is danger of injury or death and secondly the danger of damage to the appliance.

Please read these instructions before using the cleaner.

Location

- Do not use or keep this product outside.
- Do not store the appliance near hot surfaces eg. ovens or heating appliances.

Mains lead

- Do not allow the mains lead to become strained or run this appliance over it.
- If the electrical cable becomes damaged, the cable assembly must be replaced. Do not attempt this task yourself, contact the helpline number that is found at the bottom of the page.

Personal safety

- **WARNING: Keep loose clothing, hair, fingers etc. away from the turbo nozzle during use.**
- **WARNING: When using the cable rewind, always hold the plug as the cable will rewind quickly.**
- The plug must be removed from the wall socket before cleaning or maintaining the appliance.

- Never use in the presence of explosive liquid or vapours.
- Use only Morphy Richards spare parts and accessories.

- Never pick up inflammable or poisonous liquids such as petrol, copier toner or other volatile substances. Never pick up acids, asbestos or asbestos dust.

- Never touch the plug or cable with wet hands.
- Unprofessional repairs can be dangerous for users.
- The appliance must never be left running unsupervised.

- This appliance is intended for domestic use only. Misuse or use for commercial or any other purpose will render the guarantee invalid.

- Always disconnect the appliance from the mains supply after use or prior to emptying, cleaning or maintaining.

- To protect against fire, electric shock and personal injury, do not immerse in water or other liquid.

- This appliance is not intended for use by persons (including children) with reduced physical, sensory or mental capabilities, or lack of experience and knowledge, unless they have been given supervision or instruction concerning the use of the appliance by a person responsible for their safety.

Product safety

- Never use the appliance without the filters being installed.
- Never use the appliance to vacuum hot ashes, broken glass, sharp objects or liquids.

- Never modify the cleaner in any way.

Children

- Children do not understand the dangers associated with operating electrical appliances. Never allow children to use this appliance.
- Children should be supervised to ensure that they do not play with the appliance, or stumble over the power cord.

ELECTRICAL REQUIREMENTS

Check that the voltage on the rating plate of your appliance corresponds with your house electricity supply which must be A.C. (Alternating Current).

If the socket outlets in your home are not suitable for the plug supplied with this appliance, the plug should be removed and the appropriate one fitted.

If you cut off the plug and let go of the cable, it will rewind into the machine, therefore you must pull out a length of cable and secure it before cutting the plug off and re-fitting a new one.

WARNING: The plug removed from the mains lead, if severed, must be destroyed, as a plug with a bared flexible cord is hazardous if engaged into a live socket outlet.

Should the fuse in the 13 amp plug require changing, a 13 amp BS1362 fuse must be fitted.

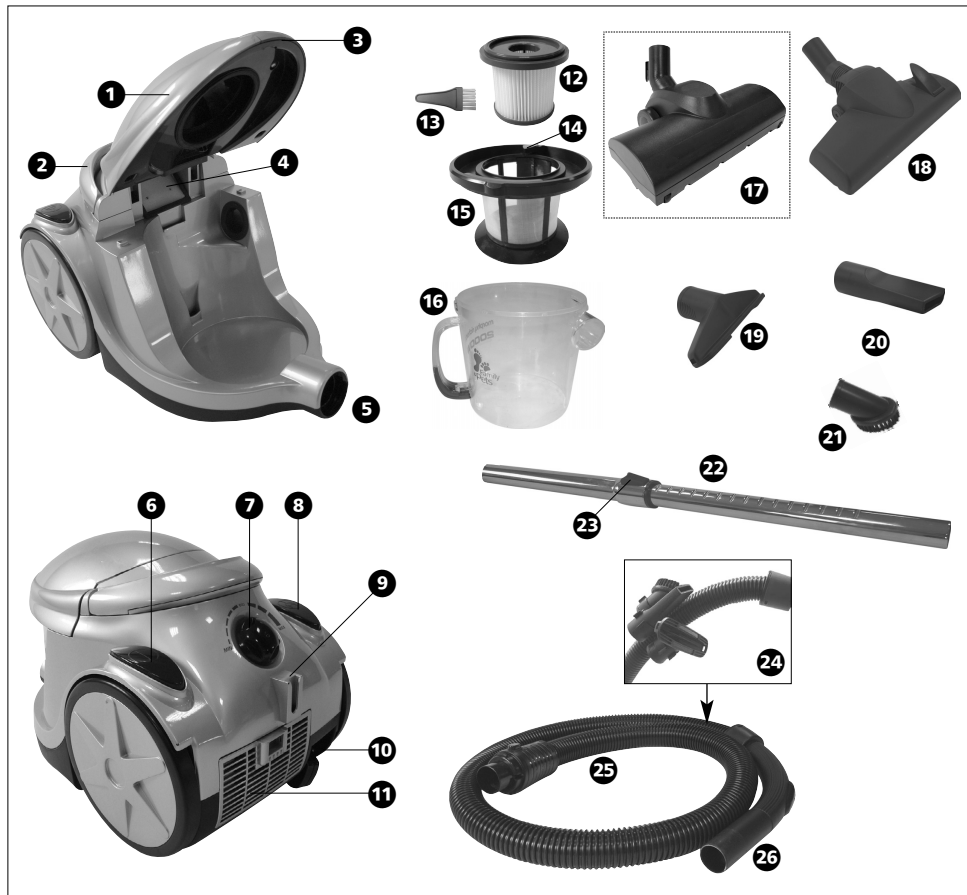

FEATURES

- | | | |
|--|--|--|
| 1 Dust compartment lid | 9 Tube standby slot | 18 Combination floor nozzle |
| 2 Carrying handle | 10 Power cable and plug, in storage area | 19 Upholstery nozzle |
| 3 Dust compartment lid release catch (Note: If the dust canister filter is not fitted, the cover will not close) | 11 Exhaust air filter cover | 20 Crevice tool |
| 4 Motor protection filter | 12 Pleated filter canister | 21 Dusting brush |
| 5 Hose inlet | 13 Filter brush | 22 Telescopic metal tube |
| 6 On/off switch | 14 Filter clip | 23 Telescopic tube slider release button |
| 7 Eco Switch | 15 Mesh filter | 24 Clip-on tool holder |
| 8 Cable rewind switch | 16 Dust canister | 25 Suction hose |
| | 17 Turbo brush (certain models only) | 26 Suction hose handle with air flow control |

OPERATING THE APPLIANCE OPERATION

Suction hose

Push the 360° rotating head on the suction hose **25** into the suction hose inlet **5** on the vacuum cleaner.

To remove, press the buttons on the hose and pull out.

The appropriate cleaning tool can be attached directly to the other end of the suction hose or the telescopic metal tube can be used between the suction hose and the tool.

TOOLS AND ACCESSORIES

Telescopic tube

Attach the telescopic tube **22** to the handle end **26** of the hose **25**. Extend to the required length by pressing down the slider release **23** and pulling out the tube **22**. Attach the required accessory to end of the tube.

Combination floor nozzle **18**

This nozzle is suitable for general purpose cleaning on a wide variety of floor coverings.

Turbo brush **17** (certain models only)

This nozzle is suitable for cleaning and rejuvenating cut pile carpets and is ideal for picking up stubborn dirt and pet and human hairs.

Cleaning the turbo nozzle

The turbo nozzle should be regularly cleaned and any hairs or fibres wrapped around the brush bar removed to maintain optimum performance.

A cover on the base allows access to the turbine in case any large particles become trapped.

Standard accessories



Application



Curtains and delicate fabrics



Textiles and upholstery

Shelves and hard surfaces



Carpets and other textile floor coverings (brushes up)



Settings for heavy dirt and smooth floors (brushes down)

Ideal for pet and human hair removal

Other accessories include:

- **Upholstery nozzle **19**** for sofas, armchairs etc.
- **Crevice tool **20**** for awkward places, corners and behind radiators etc.
- **Dusting brush **21**** for pelmets, delicate objects etc.

Tool storage

The upholstery nozzle **19**, and the crevice tool **20** and dusting brush **21** may be stored on the hose using the clip-on tool holder **24**.

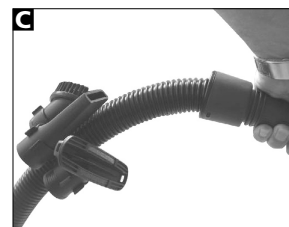

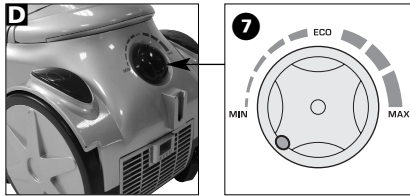

Switching on

Always pull out the supply cable to its maximum length. Plug the appliance into the mains supply.

Ensure that the Eco Switch **7** is set to the required setting before switching the cleaner on **D**. Push the on/off switch **6** to start the motor.







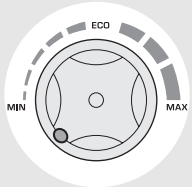

Controlling suction power

The suction power can be varied to suit the surface being cleaned, by using the Eco Switch **7** **E**, see table for guideline settings.

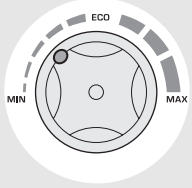
The suction power can also be adjusted using the fingertip control on the handle **26** **F**.

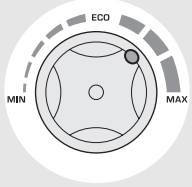
Closed: full suction

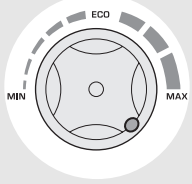
Open: reduced suction

Eco Switch Power setting	Application
	 Curtains and delicate fabrics
	 Textiles and upholstery
	 Floor coverings, such as rugs, economy setting for carpets
	 Carpets or hard floor coverings

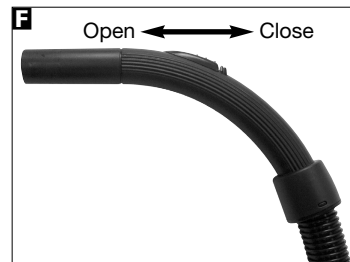

Recommended settings

Alter the power setting to suit the surface (as shown in the table, left).



Tube parking **G**

During short breaks in cleaning, the tubes can be held in an upright, 'standby' position. Rotate the floor nozzle until the lug on the neck can be fitted into the tube standby slot **G** on the rear of the appliance, whilst you move furniture for instance.

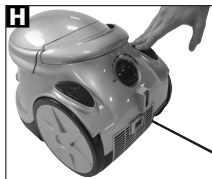

IMPORTANT: Ensure that the appliance is never left unattended whilst it is switched on.

After use, the tube and floor nozzle may be stored in this position, but ensure the tube is in the compacted position.



Switching off **I**

Switch off the appliance. Remove the plug from the mains supply and rewind the power cable using the cable rewind switch **I**.



WARNING: When using the cable rewind, always hold the plug as the cable will rewind quickly.

MAINTENANCE

EMPTYING THE DUST CANISTER

- 1 Turn the cleaner off and unplug from the mains switch.
- 2 Pull up on the lid release clasp on the front rim of the lid **K**. Open the lid and pull the canister **L** away from the main body **I**.
- 3 Hold the dust canister over the dustbin. Lift out the mesh filter **L** and empty the dust canister into the dustbin.



FILTERS

Cleaning the dust canister filters

Clean the dust canister filters every time the canister is emptied to maintain high performance.

After emptying, brush off any fluff that has collected on the mesh filter.

Push aside the spring-loaded filter clip **K** and lift out the pleated filter **L**. Tap or brush the filter to remove dust from the pleats.

Use the small filter brush **M** provided to thoroughly clean the pleats of the filter **L**.

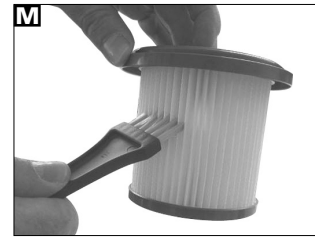

Every three months, rinse the filter in luke warm water then leave to air-dry. **The filter must be completely dry before re-fitting.**

Changing/cleaning the motor protection filter

The motor protection filter **N** is accessible from the dust compartment only when the dust canister has been removed first.

IMPORTANT: Never use the appliance without the motor protection filter installed, otherwise damage to the motor may occur which would not be covered by the guarantee.

- 1 The filter is located under the lid hinge. Take out the filter and clean by shaking or by washing **N**.



- 2 To wash the filter, gently wash in luke warm water and leave to air dry. Do not use detergents.

Ensure the filter is fully dry before replacing into the machine.

- 3** Place the filter back into position.

IMPORTANT: Check this filter every time the dust canister is emptied and clean if necessary.

Changing/cleaning the exhaust air filter

We recommend the exhaust air filter **11** should be cleaned every six months.

Release the grill cover by pressing down on the release button, below the tube standby slot **9** **10**. Remove the filter cover by pulling the tab **12**. Take out the filter and shake clean. To wash the filter, gently wash in luke warm water and leave to air dry. Do not use detergents.

Ensure the filter is fully dry before replacing into the machine.

HINTS AND TIPS

Cleaning and maintenance

Unplug from the mains supply before cleaning. The vacuum cleaner, especially the dust compartment and all accessories, can be cleaned using a damp cloth or a non-abrasive domestic cleaner and wiped dry.

To keep the underside of the floor nozzle clean, vacuum it at regular intervals using the crevice tool.

Purchasing filters

Use only genuine replacement filters which can be purchased from specialist retailers or by calling our helpline number below.

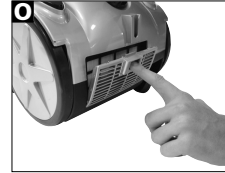

HELPLINE

If you have any difficulty with your appliance, do not hesitate to call us.

We are more likely to be able to help than the store from where you bought it.

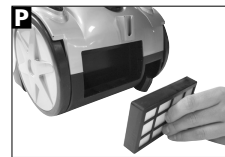

Please have the following information ready to enable our staff to deal with your query quickly.

- Name of the product
- Model number as shown on the underside of the appliance.
- Serial number as shown on underside of the appliance.

UK Helpline 0844 871 0949

Replacement Parts 0844 873 0715

Ireland Helpline 1800 409 119

WEBSITE

You may also contact us through our website, or visit the site to browse and purchase appliances, spare parts and accessories from the extensive Morphy Richards range.

www.morphyrichards.com

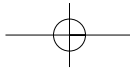

YOUR TWO YEAR GUARANTEE

It is important to retain the retailer's receipt as proof of purchase. Staple your receipt to this back cover for future reference.

Please quote the following information if the product develops a fault. These numbers can be found on the base of the product.

Model no.

Serial no.

All Morphy Richards products are individually tested before leaving the factory. In the unlikely event of any appliance proving to be faulty within 28 days of purchase, it should be returned to the place of purchase for it to be replaced.

If the fault develops after 28 days and within 24 months of original purchase, you should contact the Helpline number quoting Model number and Serial number on the product, or write to Morphy Richards at the address shown.

You may be asked to return a copy of proof of purchase.

Subject to the exclusions set out below (see Exclusions), the faulty appliance will then be repaired or replaced and dispatched usually within 7 working days of receipt.

If you suspect a fault, follow the simple checks detailed below before retrying the appliance or calling the helpline.

Morphy Richards products are intended for household use only.

Morphy Richards has a policy of continuous improvement in product quality and design. The company, therefore reserves the right to change the specification of it's models at any time.

- Check the filters for blockages.
- Check the tools / tubes for blockages.
- Check the plug is firmly in the socket.
- Check the socket is working by trying another appliance.
- Check the fuse in the plug.

If, for any reason, this item is replaced during the 2 year guarantee period, the guarantee on the new item will be calculated from original purchase date. Therefore, it is vital to retain your original till receipt or invoice to indicate the date of initial purchase.

To qualify for the 2 year guarantee, the appliance must have been used according to the instructions supplied.

EXCLUSIONS

Morphy Richards shall not be liable to replace or repair the goods under the terms of the guarantee where:

- 1 The fault has been caused or is attributable to accidental use, misuse, negligent use or used contrary to the manufacturer's recommendations or where the fault has been caused by power surges or damage caused in transit.
- 2 The appliance has been used on a voltage supply other than that stamped on the products.
- 3 Repairs have been attempted by persons other than our service staff (or authorised dealer).

- 4 The appliance has been used for hire purposes or non domestic use.
 - 5 The appliance is second hand.
 - 6 Morphy Richards are not liable to carry out any type of servicing work, under the guarantee.
 - 7 The guarantee excludes consumables such as some filters.
- This guarantee does not confer any rights other than those expressly set out above and does not cover any claims for consequential loss or damage. This guarantee is offered as an additional benefit and does not affect your statutory rights as a consumer.
 - This guarantee is valid in the UK and Ireland only.



For electrical products sold within the European Community. At the end of the electrical products useful life, it should not be disposed of with household waste. Please recycle where facilities exist. Check with your Local Authority or retailer for recycling advice in your country.

morphy richards®

**The After Sales Division
Morphy Richards Ltd**
Mexborough, South Yorkshire,
England, S64 8AJ

Helplines (office hours)
UK 0844 871 0949
Spare Parts 0844 873 0715
Republic of Ireland 1800 409 119

VC73270 MUK Rev 2 10/08

For details of other Morphy Richards products, plus replacement parts and accessories, please see our website:

www.morphyrichards.com

